

# VE1/36/95 - VE3/36/95 MINI VIBRATOR

VE3/36/95 & VE1/36/95 combine the dimensions and centrifugal force of a small unit with robust parts and heavy duty construction of a larger unit. It is designed to work non stop for a long time while still be able to fit in very little spaces.

Force output is adjustable:

from 30 lbs up to **114 lbs.** basic model  
from 50 lbs up to **167 lbs.** XL model

Single phase units come standard with cable and capacitor. Upon request they can be supplied complete with a Control Box with ON/OFF Switch and Overload protection.

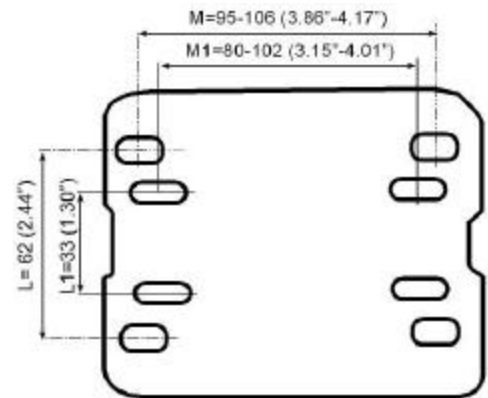
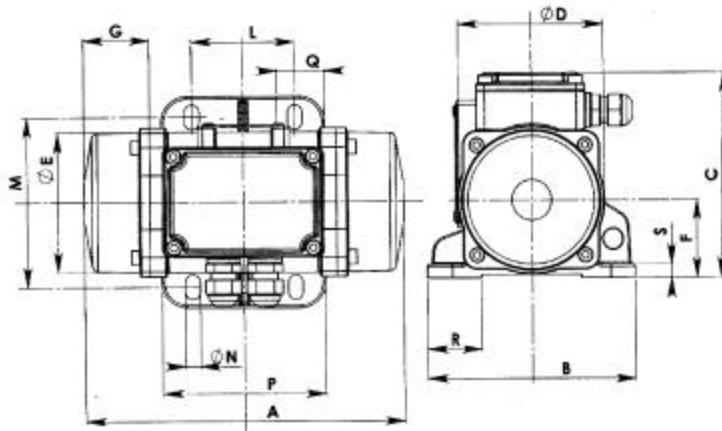

A:	7.65"	F:	1.81"	P:	3.89"
B:	4.92"	G:	1.38"	Q:	1.18"
C:	4.80"	L:	<b>2.44"</b>	R:	1.22"
D:	3.42"	M:	<b>3.86-4.17"</b>	S:	0.32"
E:	3.23"	N:	0.35"		

## PERFORMANCE DATA

<b>Max Force Output</b>	standard	<b>114 lbs</b>
	XL	<b>167 lbs</b>
<b>Weight</b>		9 lbs
<b>Bearings</b>		6202.ZZ.C3
<b>Speed:</b>		3600 rpm
<b>Unbalance</b>		0.3 in-lbs
<b>VE1/36/95</b>		
Voltage	115 v	
Amp draw.	0.92	
H.P.	0.14 HP	
Capacitor	8 mF	
<b>VE3/36/95</b>		
Voltage	230-460 v	
Amp. draw	0.40-0.20	
H.P.	0.15 HP	



## AVAILABLE OPTIONS

- VE3/36/95** = Standard Threephase
- VE3/36/95 XL** = Higher Force Threephase
- VE1/36/95** = Standard Single Phase
- VE1/36/95 XL** = Higher Force Single phase

This model is widely used in small hoppers and bins with cone material weight of up to 1500 lbs