

# FKL

# IMPACTOR

FKL **impactor** generates single blows similar to a sledgehammer.

The sudden impact shock is able to dislodge sticky or clinging products.

The **impactor** high acceleration is capable of moving products that don't usually respond to standard rotary and linear vibration.

Time between impacts is adjustable from 3 seconds up to 1 day depending on timer regulation



## PERFORMANCE DATA

MODELS		FKL 50	FKL 100	FKL 150	FKL 200
PRESSURE	PSI	60-100	60-120	60-120	60-120
FREQUENCY	impacts per minute	0-20	0-20	0-20	0-20
ACCELERATION	inch-lbs	90	270	450	800
IMPACT FORCE EQUIVALENT	lbs	100	300	600	1200
INNER PISTON WEIGHT	Kg	0.4	1.3	3.6	5.7
CONSUMPTION	cubic feet / impact	0.02	0.07	0.15	0.30
BIN WALL THICKNESS (max)	inches (mm)	1/8" (3 mm)	1/8" -1/4" (5 mm)	3/16"-5/16" (8 mm)	1/4" - 1/2" (12 mm)
FKL WEIGHT	lbs	4	10	21	32

## How it works

Compressed air keeps the piston against the spring.

When air is rapidly vented, the spring fires the piston against the bottom plate.

When air is reapplied the piston is reloaded.

## Applications

Able to knock off stubborn material adhering to hopper walls.

Preventing bridging and ratholing.

Next step whenever standard rotary or linear vibrators can not get the job done.

## Construction

FKL impactor is made of a machined aluminum case and of a hardened steel piston.

The base plate is made of aluminum with an integrated impact plate of a noise reducing special plastic resistant to impacts.

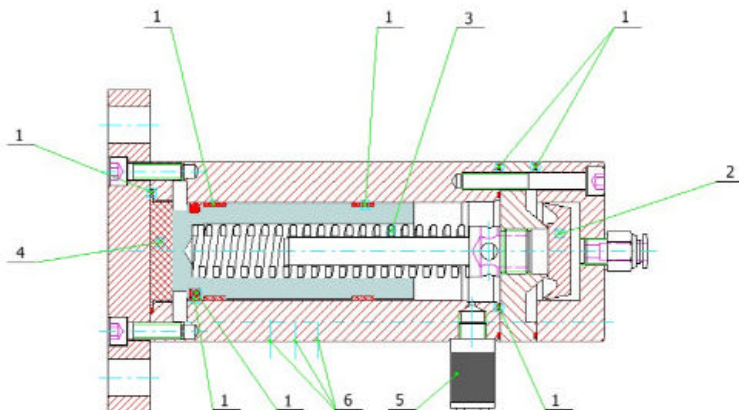

1	Seals & O-Rings	4	Impacting plate
2	Inner air valve	5	Air muffler
3	Piston spring	6	Force adjustment

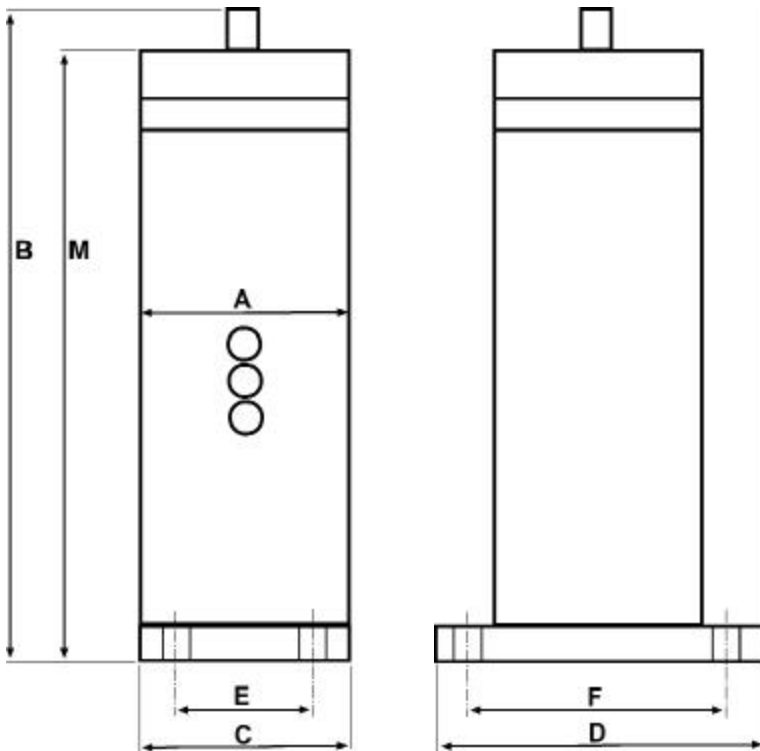

**Accessories** that control the pulse frequency (like an electronic **timer** and a normally closed 3 ports **solenoid valve**) are available upon request



DIMENSIONS									
MODEL		A	B	C	D	E	F	G	M
FKL 50	inches	2.52"	7.64"	2.60"	4.53"		3.54"	0.51"	6.97"
	metric mm	64	194	66	115		90	13	177
FKL 100	inches	3.50"	9.53"	3.54"	5.12"	1.97"	3.94"	0.51"	8.82"
	metric mm	89	242	90	130	50	100	13	224
FKL 150	inches	4.65"	12.99"	round base	5.51"		4.53"	0.51"	12.20"
	metric mm	118	330		140		115	13	310
FKL 200	inches	5.63"	16.14"	round base	7.09"		5.98"	0.51"	
	metric mm	143	410		180		152	13	



### General Maintenance tips

Always use a regulator and a 5 micron filter to control and clean air supply

Vibrator must be securely mounted to a flat smooth surface. Use locknuts, locking washers or loctite when tightening bolts.

Temperature should not exceed -30° F and 180° F

### Air Lubrication tips

The Impactor can be operated with dry compressed air and, thus, not lubricated. If compressed air containing oil is selected for operation of the impactor, then such air must always be used since impactor factory added lubrication will be flushed out by the lubricated air. Make sure compressed air is off during installation and maintenance

# POWTEK

2500 Pearl Buck Rd - Suite I Bristol, PA 19007  
 Tel: 215-788-2888 FAX: 215-788-2883  
[powtek@comcast.net](mailto:powtek@comcast.net) [www.powtek.us](http://www.powtek.us)