

P O W T E K

AFC System - Quick Mount Electric Vibrator

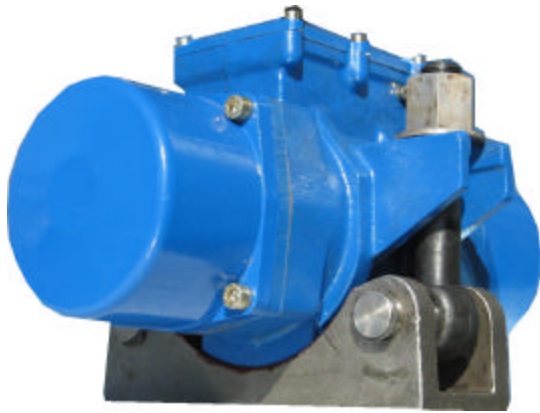

THE BEST SOLUTION FOR PORTABLE SYSTEMS

AFC vibrators are ideally suited to **Precast applications**. Whenever there is a need to move electric vibrators from concrete mold to concrete mold, **the ease of the AFC** Quick Mount Cradle Lug Bracket is unrivaled.

The **alignment** is **automatic** with the vibrator claw inserted into the lower end of the cradle bracket.

This also **holds** the **vibrator's weight**.

No need to insert bolts, washers and nuts each time you have to move a vibrator.

The AFC System has **only one nut** to tighten needing only one person to change a vibrator. Thus **time saving** in relocating is as much as **70%** compared with the standard vibrator. Besides the reduced cost of labor, this leads to a much **lower downtime** where most of the time is used in pouring concrete instead of tightening bolts!

In addition to the standard 230-460 Volts, the AFC System can be supplied with 48 Volts, which is advisable for use in wet environments where accidental contact with high voltage could be very hazardous to the operator.



Standard POWTEK
M23 Cradle Lug Bracket
fit both models.
Washer is permanently
attached to the Lug Nut.



Eccentric Weights
Adjustable in five positions
from 30% up to 100%

PERFORMANCE DATA			
MODEL NUMBER		AFC 36/1600	AFC 36/3000
Force Output	lbs	1870	3168
Frame Size		AF 10C	AF 15C
Speed	rpm	3600	3600
Weight	lbs	44	63
Input Power	H.P.	1.15	1.5
Amp Draw 230 V	amps	2.2	3.0
Amp Draw 460 V	amps	1.1	1.5
Amp Draw 48 V	amps	12	16
Lug Bracket Model		M 23	M 23
Bearing Type		6307	NJ 306
Bearing Life (at max force)	hours	1450	3100

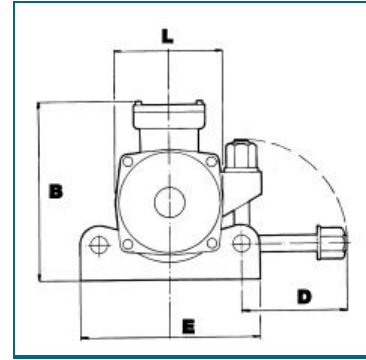
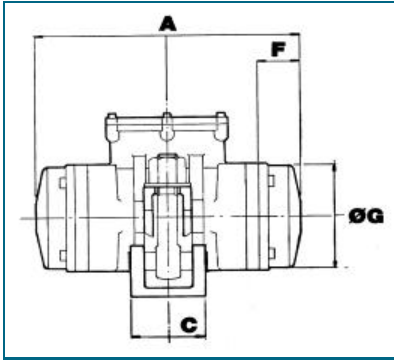

DIMENSIONS								
MODEL	A	B	C	D	E	F	G	L
AFC/36/1600	14.02"	8.58"	3.31"	5.71"	9.45"	3.23"	4.80"	4.96"
AFC/36/3000	15.83"	8.86"	3.31"	5.71"	9.45"	4.17"	5.28"	5.5"

Mounting is totally interchangeable with the **CR family** of Concrete Roller Vibrators



POWTEK
INDUSTRIAL VIBRATORS

3060 BRISTOL ROAD SUITE 236
BENSALEM, PA 19020
TEL: 215-752-9901 FAX: 215-702-1607
powtek@powtekcorp.com
www.powtek.us

Same performance and same bearing life as the Powtek VE3/36/2800 Form Vibrator

